

BIRCHILL CRES

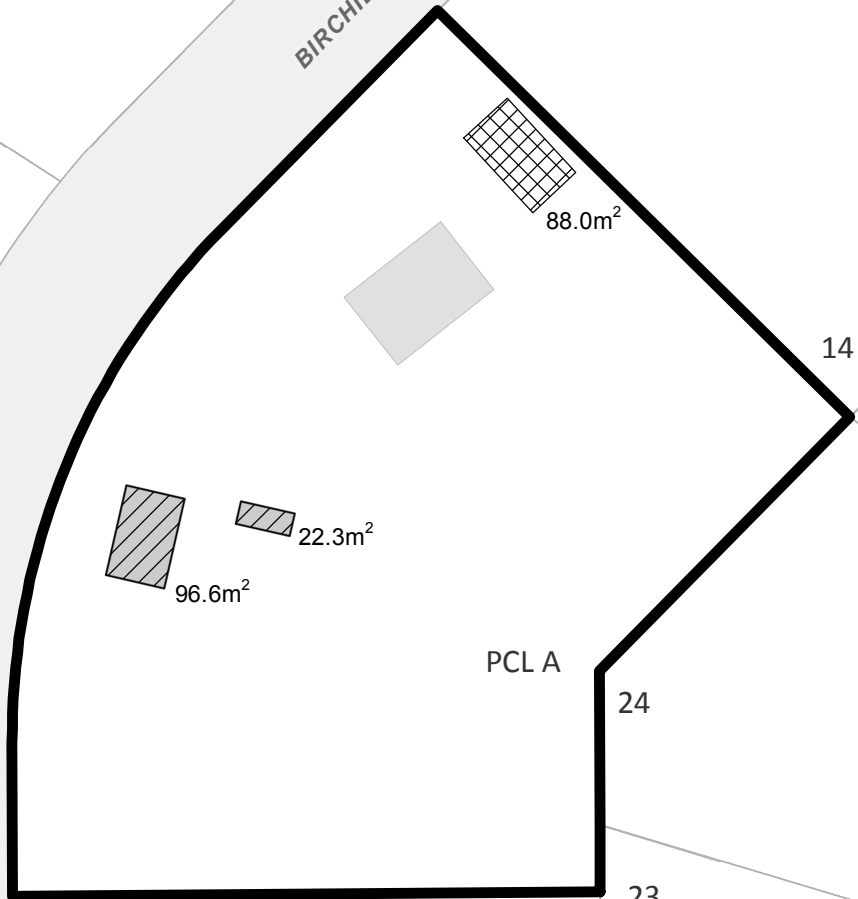

88.0m<sup>2</sup>

22.3m<sup>2</sup>

96.6m<sup>2</sup>

PCL A

14

25





24

23

Vary City of Prince George Zoning Bylaw No. 7850, 2007 as follows:  
Vary Section 9.5.6 1. by increasing the total combined gross floor area of accessory buildings and structures on a site from 90.0 m<sup>2</sup> to 207.0 m<sup>2</sup>

18

22

-  Proposed Accessory Building
-  Existing Accessory Building
-  Existing House
-  Subject Parcel
-  Parcel

0 5 10 20 30 Meters  
 Coordinate System: NAD 1983 UTM Zone 10N  
 Projection: Transverse Mercator  
 Datum: North American 1983  
 1:1000

**Exhibit "A" to VP100522**  
 Parcel A (Being a consolidation of Lots 15 and 16,  
 See CA7019370), DL 1593, CD, Plan 15680

